

Studio Röder  
Spatial Design

GER / CHF  
studioröder.com

@studioroder  
info@studioröder.com

Selected Works

2018

2023

Furniture

Objects

Space

2017–2023	Product Design, BA	Weißensee Academy of Art, Berlin
2021	Architectural Design	Gerrit Rietveld Academie, Amsterdam
2015–2016	Art History	Leipzig University, Leipzig
2014	General Higher Qualification for University	Walter-Gropius-School, Erfurt

2022–2023	Scenography	Glass – Hand formed matter, Berlin, GER / Boda, SWE / Riihimäki, FIN
2022–2023	Scenography	Walter and Wine, Gotha, GER / Halle, GER / Baruth, GER
2021–2023	Working Student	Volkswagen Group Future Centre Europe GmbH, Potsdam
2020	Internship Design Trends	Volkswagen Group Future Centre Europe GmbH, Potsdam
2020	Volunteer Work	Connecting Continents e.V. Pemba Island, Africa
2019	Internship	Manufactory, Berlin
2018–2020	Working Student	Mikku Keramik, Berlin
2018	Employee	Jana Kubischik Interior GmbH, Berlin
2014–2015	Set Design	Schauspiel Leipzig, Leipzig

Kunststiftung Sachsen-Anhalt	Halle, GER	2023
Museum Baruther Glashütte	Baruth, GER	2023
The Finnish Glass Museum	Riihimäki, FIN	2023
Bröhan-Museum	Berlin, GER	2022
The Glass Factory	Boda, SWE	2022
Kunstforum Gotha	Gotha, GER	2022
Dutch Design Week	Eindhoven, NL	2021
BUGA (Federal Garden Festival)	Weimar, GER	2021
Galerie De Bouwput	Amsterdam, NL	2021
Grassi Trade Fair	Leipzig, GER	2019

---

SR-F:01, 21	Tube Chair	2021
SR-F:02, 21	Flip Pulpit	2021
SR-F:03, 22	Wardrobe Chair	2022
SR-F:04, 22	Invisible Table	2022
SR-F:05, 22	Tube Side Tables	2022

SR-F:01, 21

Tube Chair  
Stainless Steel

40x46x35cm

This series of stools was created with a focus on functional solutions for everyday use, in the category of handles and grasping, for a commission. They are made from high-quality stainless steel sheet and constructed with a stabilising tube in the centre. The stools were then polished to create a shiny surface. Their simple and practical design makes them easily stackable and comfortable to move, making them a perfect choice for a variety of events.







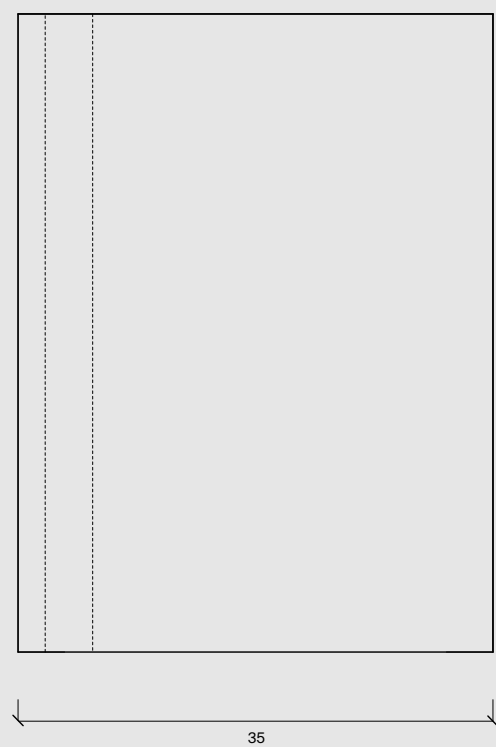



SR-F:02, 22

Flip Pulpit  
Waxed Aluminium, HMPE 1000

53x120x50cm

This work resulted in a pulpit designed for a modern church. It consists of aluminium parts that can be connected in a cross shape, as well as a white and slightly transparent front. The aluminium was sanded and coated with local beeswax. When light shines on it, the cross shape is reflected on the pulpit, creating poetic, enlightened moments. When folded, the pulpit can also be used as a bench. A multifunctional and contemporary design is the starting point of the design.

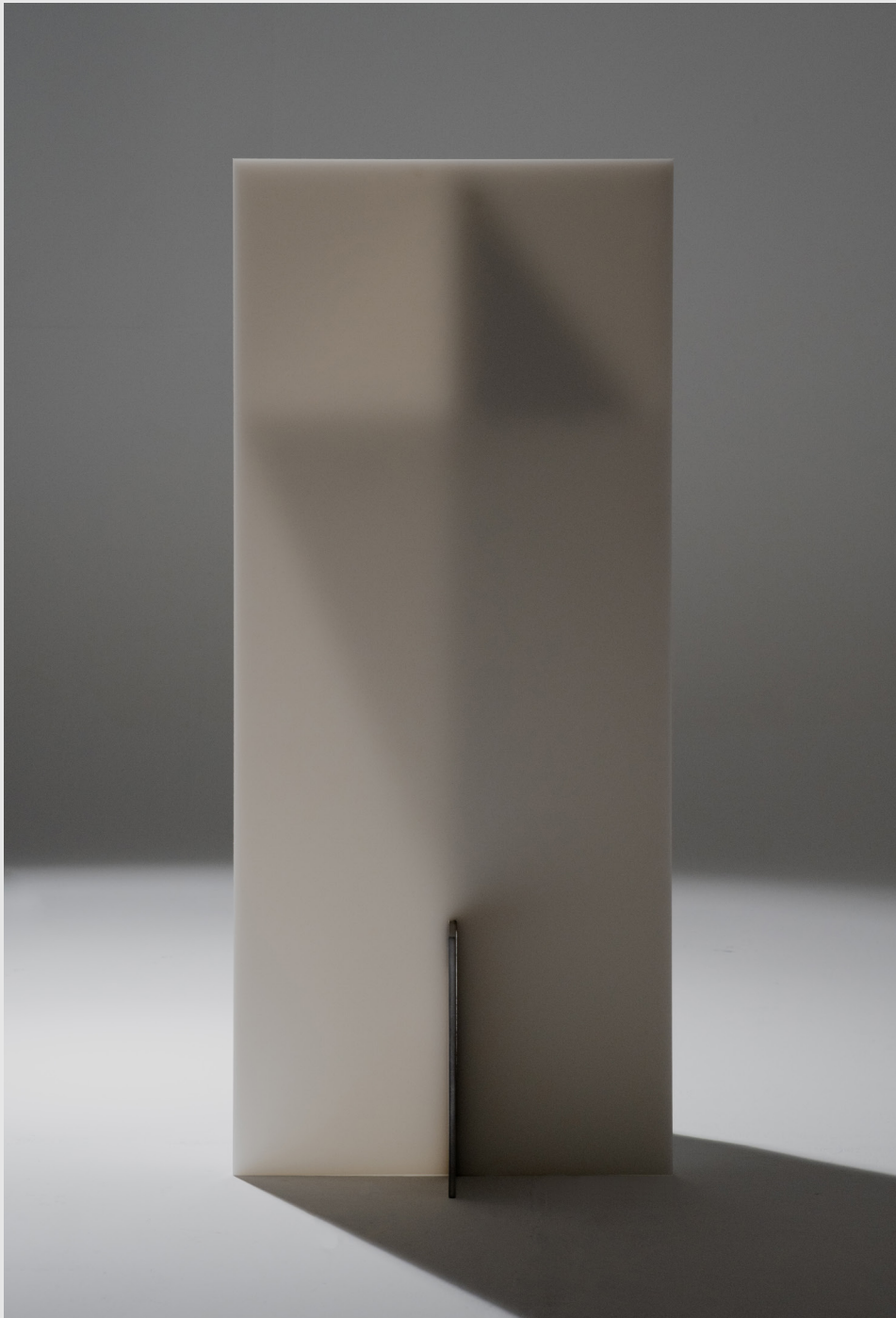

Furniture

SR-F:02, 22



Flip Pulpit

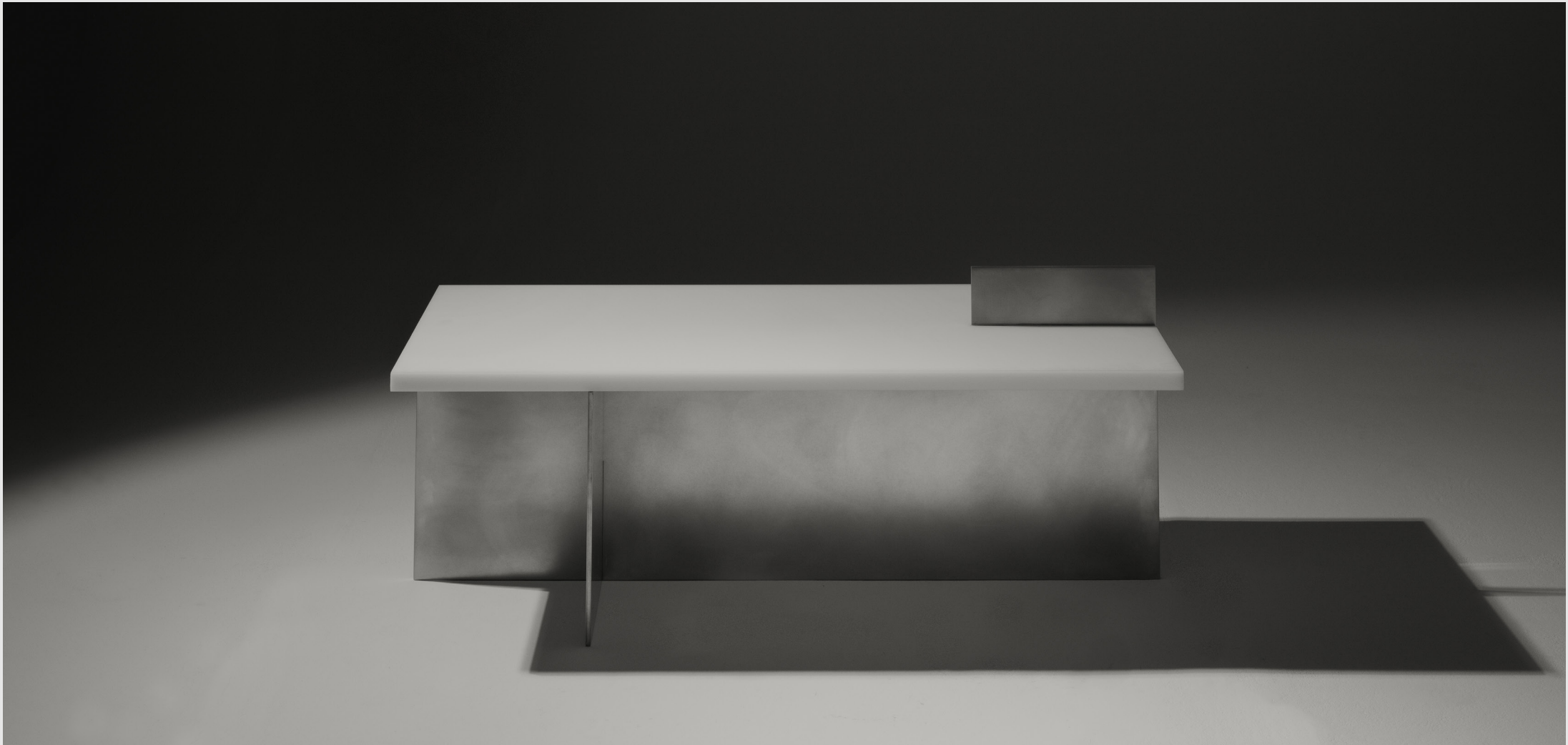

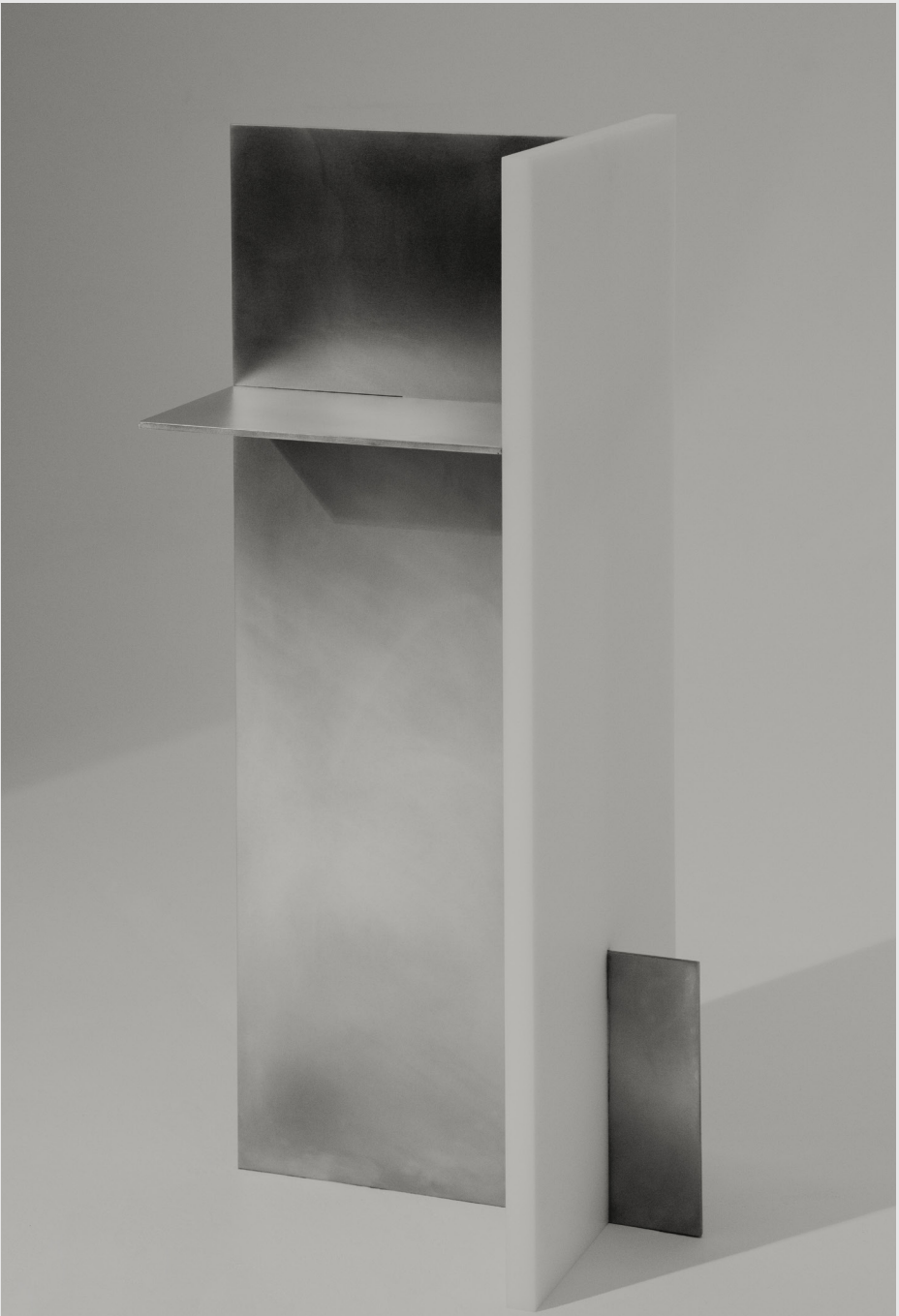

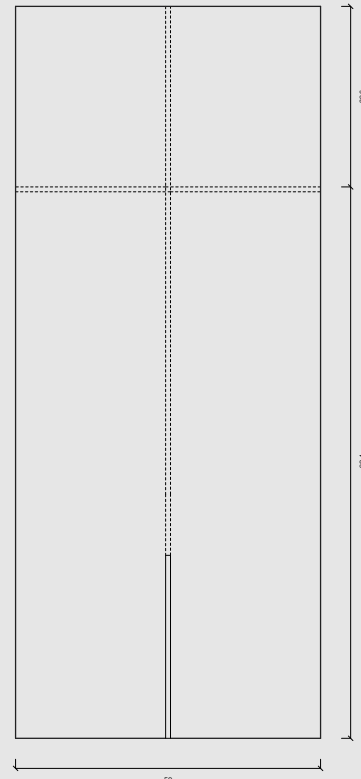
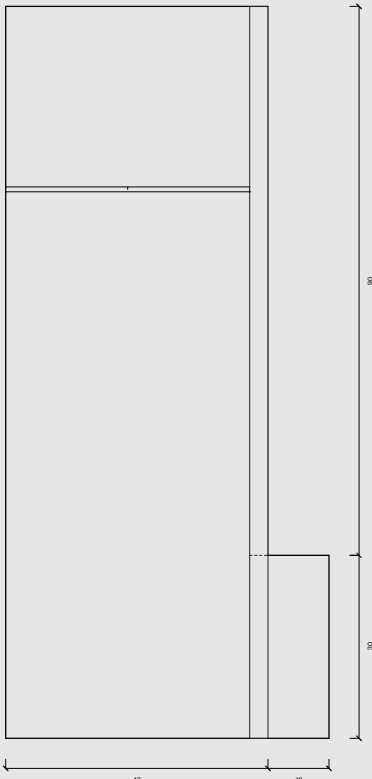
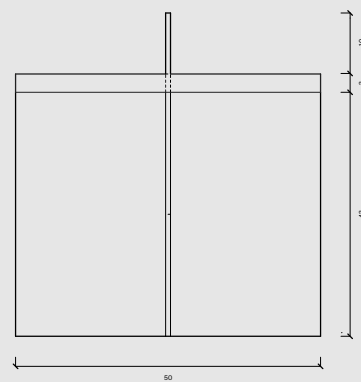

SR-F:03, 22

Wardrobe Chair  
Stainless Steel, Recycled Plastic

38x79x38cm

This chair was designed for the retail sector and is characterised by its minimalist and functional approach. A recycled white plastic backrest is framed by a polished, shiny stainless steel frame. The object serves as both a coat rack in the dressing room and an attractive display area for clothing in the store. A timeless, restrained design with a clear statement.



Furniture



SR-F:03, 22



Retail Chair







Furniture

SR-F:03, 22



Retail Chair

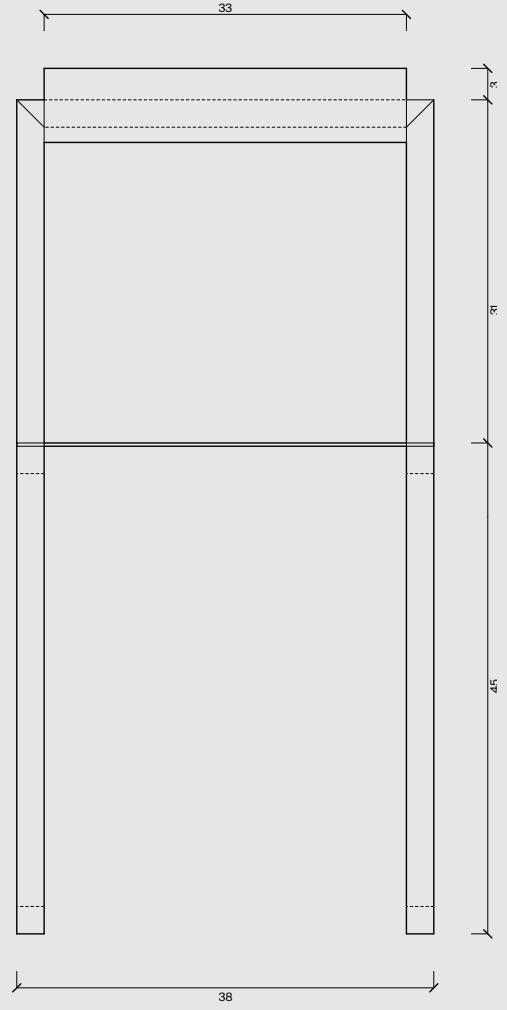
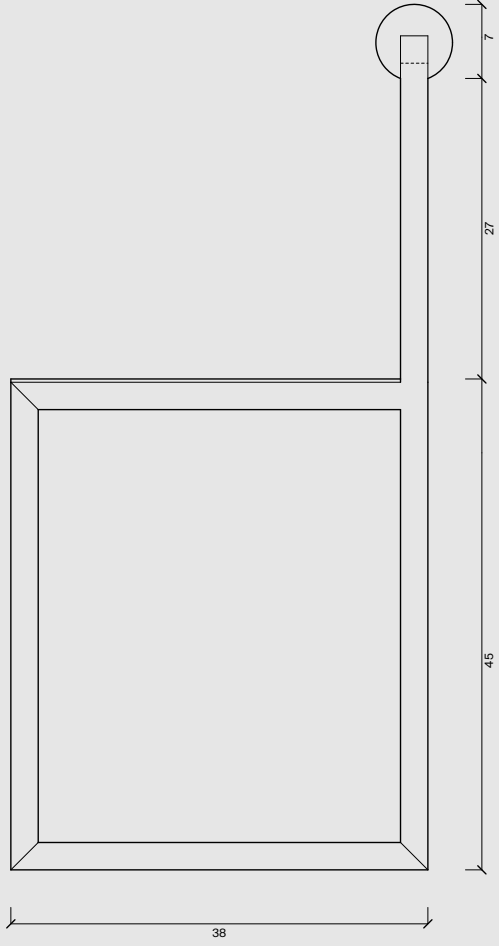

SR-F:04, 22

Invisible Table  
Recycled Plastic

46x47x46cm

The side table is the result of a study on the use of recycled white plastic. The sturdy construction guarantees stability, while the strong white and light transparency allows for perfect integration into various environments and creates a modern atmosphere.







Furniture

SR-F:04, 22



Invisible Table

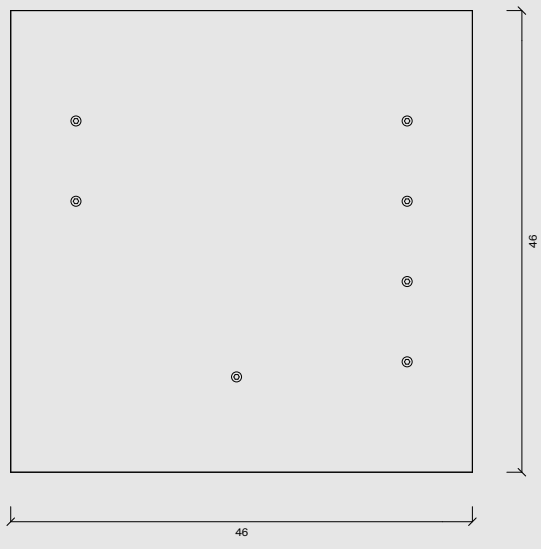
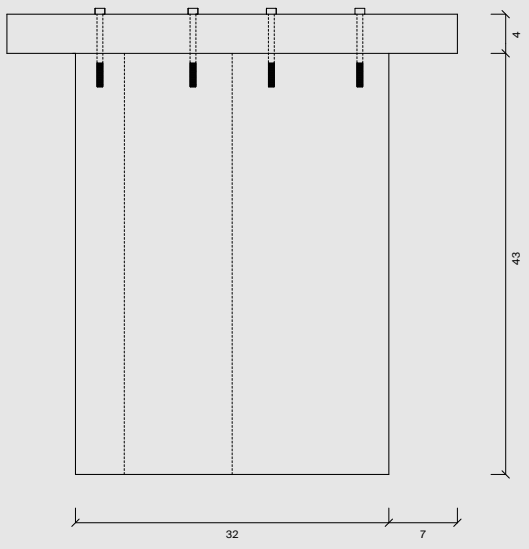
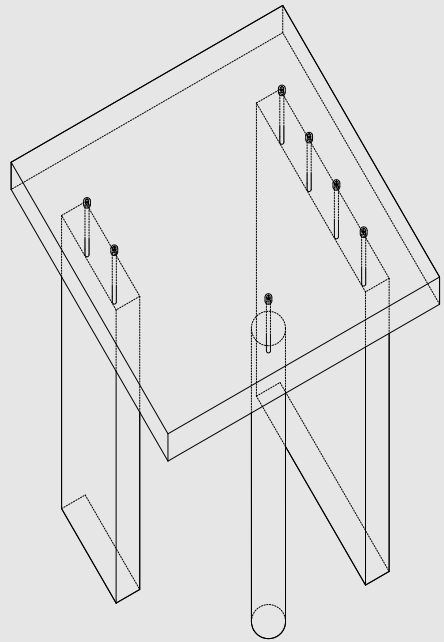

SR-F:05, 22

Tube Side Tables  
Blackened Steel

40x55.5x40cm

Two pieces of furniture were created here, inspired by rural architectural elements, through a dialogue.

The aim was to create a different perspective through new visual impressions within a smaller scale, as well as to give the furniture a texture that is related to the weathering effect that occurs over time. This was done by a manual process of burnishing multiple layers to simulate a patina look, which allows for unique textures that can be controlled and changed at will to reach various depths of the hand-blackened surface.





(a)



(b)

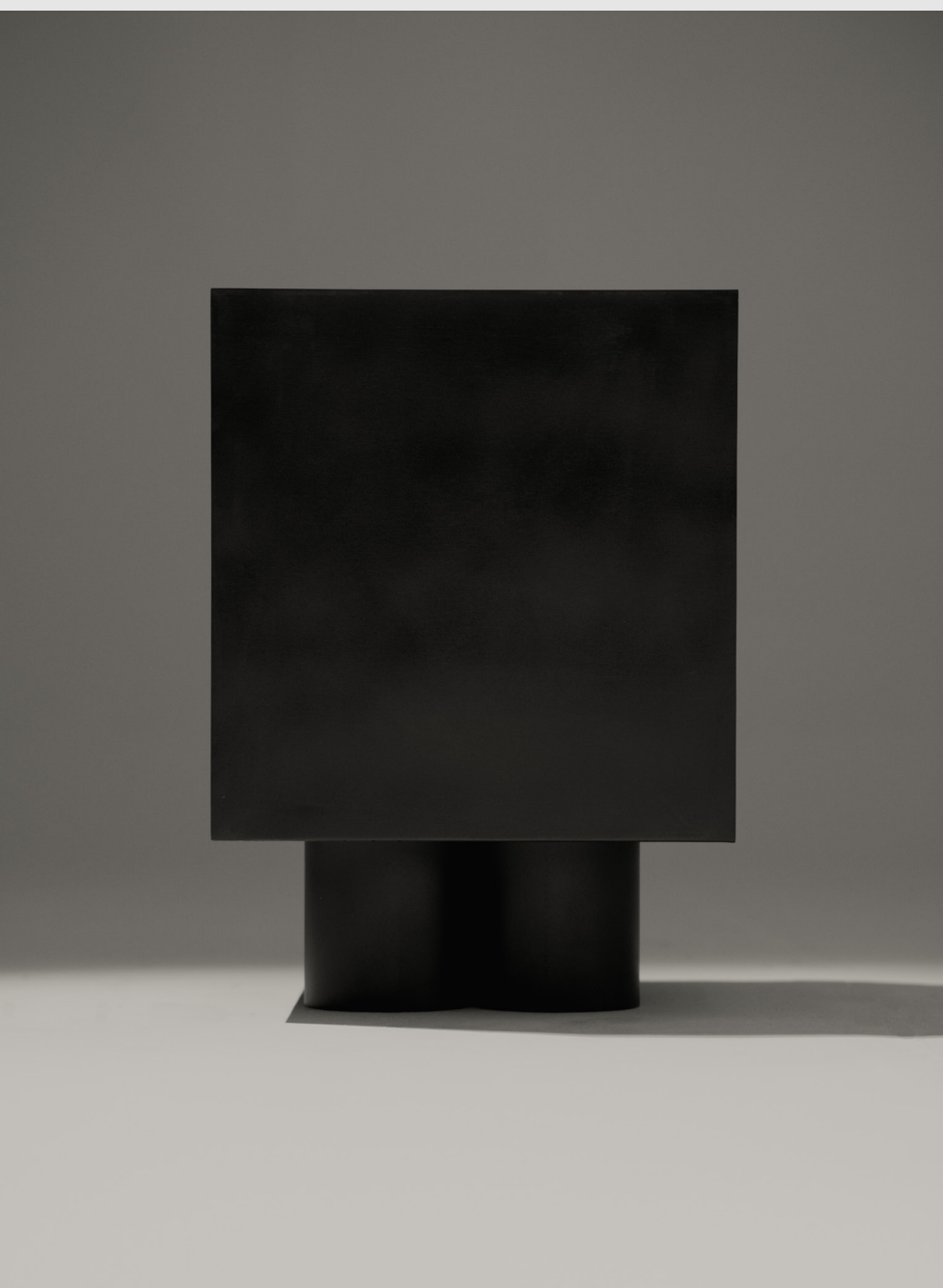

(a)

Furniture

SR-F:05, 22



(a)

Tube Side Tables



(b)



(b)

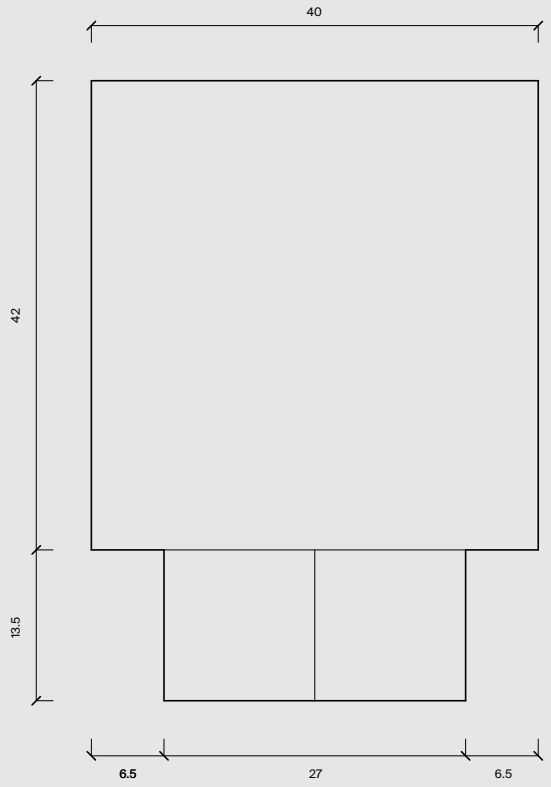

(a)

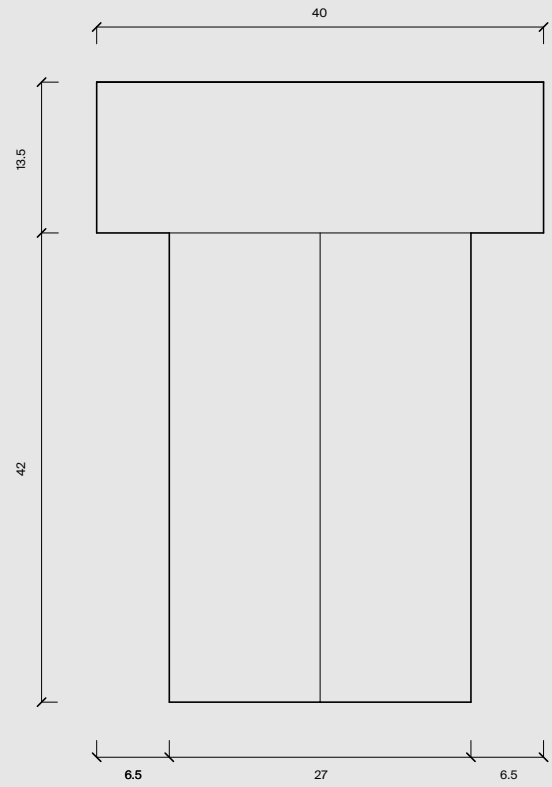

(b)

---

SR-O:01, 18      Arcus      2018

---

SR-O:02, 23      Coming Soon      2023

---

SR-O:03, 23      Coming Soon      2023

SR-O:01, 18

Arcus  
Curved Steel Round Bar

13x19cm

Inspired by the style characteristics of sacred buildings, two objects were created here from a round steel bent by heat. The surface properties and discolouration resulting from the heating process refer to the production process and give the design its individual character. The objects can be used as a weight for relaxation exercises while working at a desk and as a sculpture in a room.









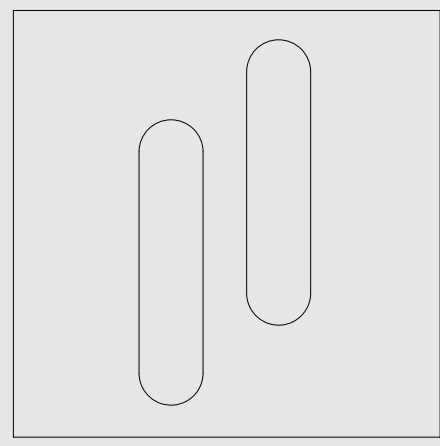
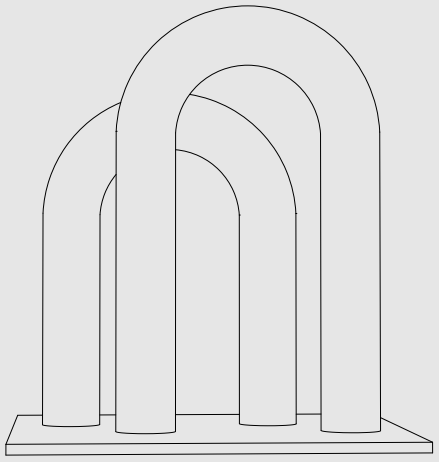
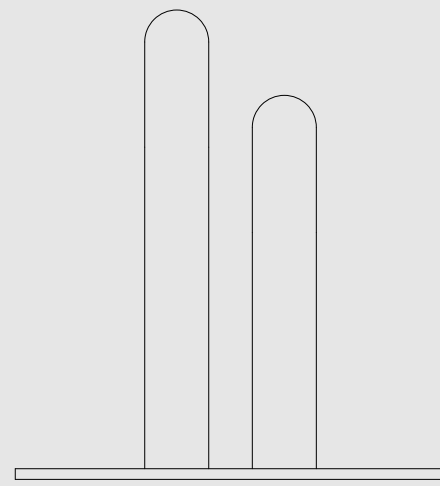
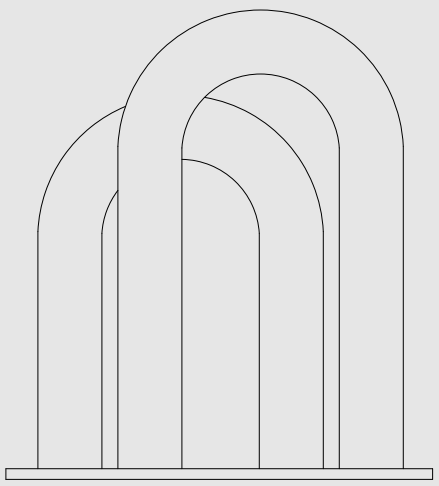

---

SR-S:01, 18	30QM	2018
SR-S:02, 21	Circular Studies	2021
SR-S:03, 21	Spatial Basics	2021
SR-S:04, 22	Route A/B	2022

---

SR-S:01, 18

30QM  
Plywood, Screen-printing panels

322.917 m<sup>2</sup>

Berlin has become increasingly popular among young creatives in recent years. Due to growth, it's becoming more and more difficult to find an affordable apartment. This project uses an old flower shop to create a retreat in the heart of Berlin. The challenge was to differentiate living areas in a room while maintaining an open living feel. The bright wood connects the different living areas, and the entrance inspired by a bridge marks the transition between inside and outside. The high ceilings and wide niches provide ample storage space, and elements such as the table are designed to fold away to create more space.



SR-S:01, 18

30QM



Space





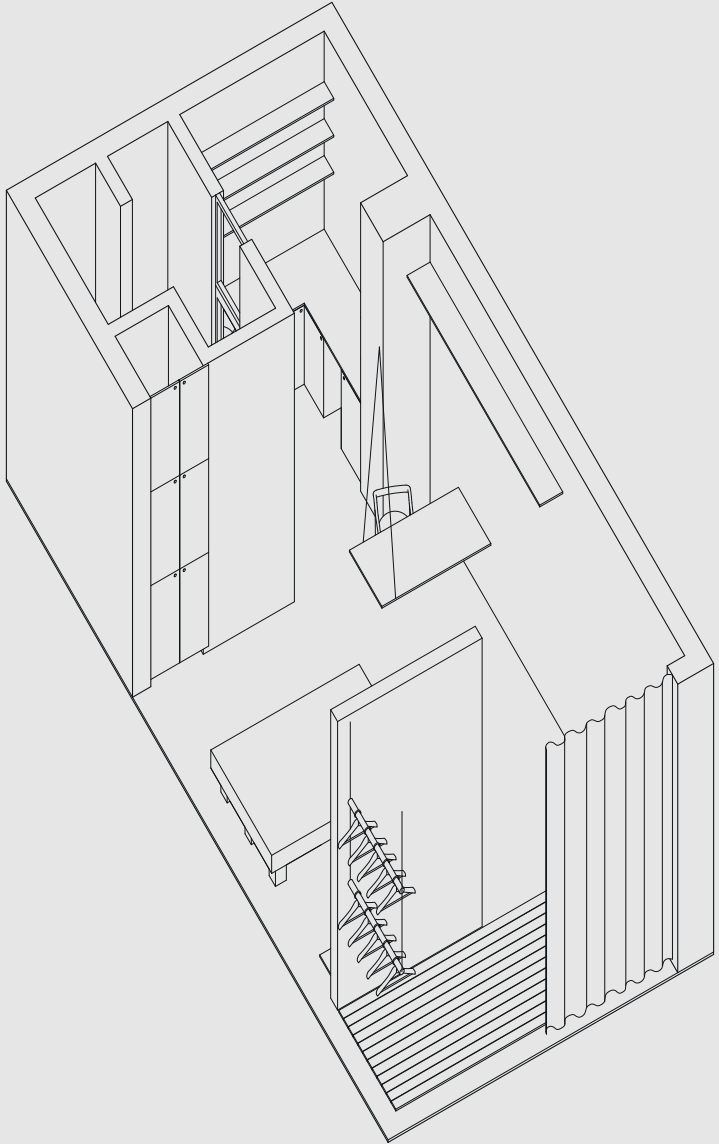



SR-S:02, 21

Circular Studies  
Bent Steel Pipe  
  
85x50x127.5cm

The installation deals with the meaning of space in architecture. The goal is to create a new understanding of the experience of space that goes beyond the purely formal, because today's understanding of architecture is primarily shaped by knowledge of form. By examining an organic, dynamic awareness of space, new possibilities are opened up to overcome rigid imaginations of space. The installation includes three forms that show different connections within the space and thus open up a new perspective.

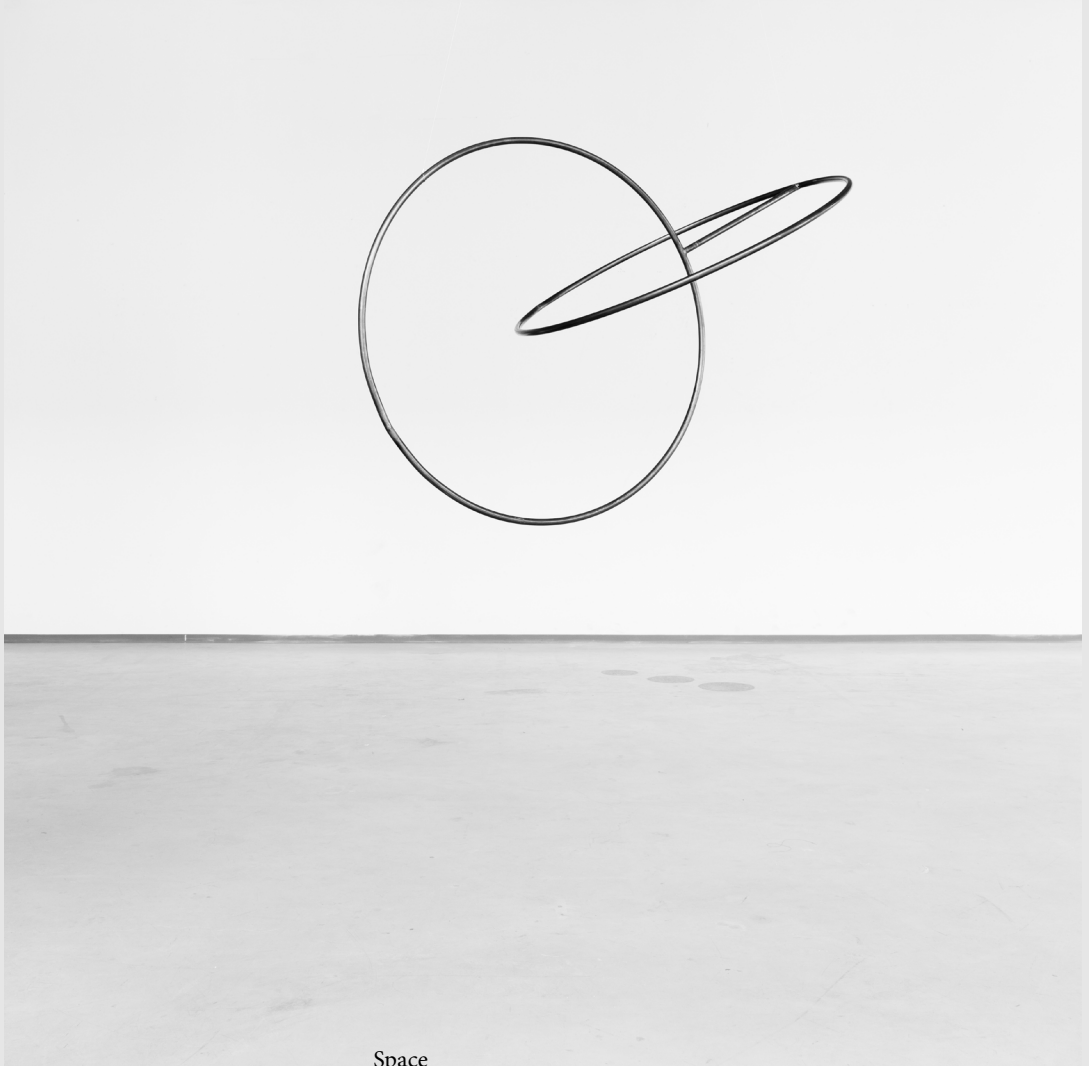
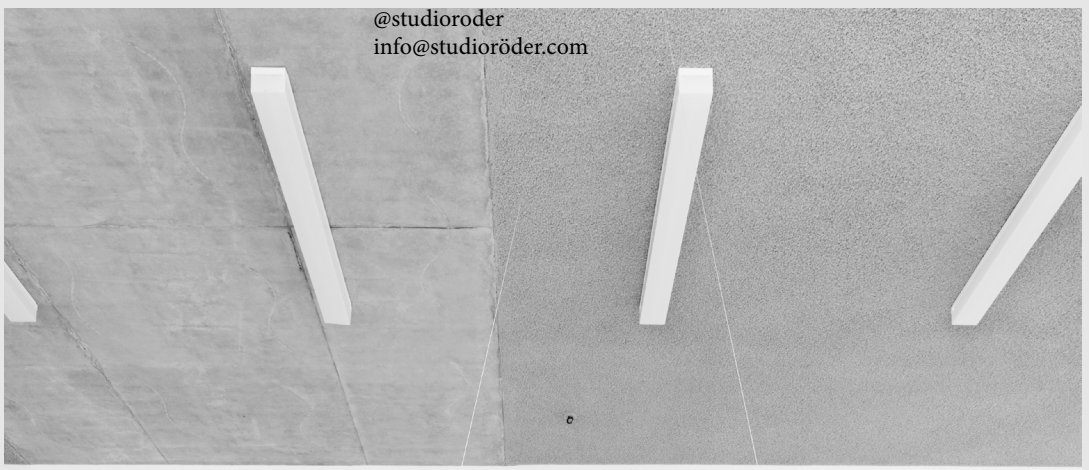
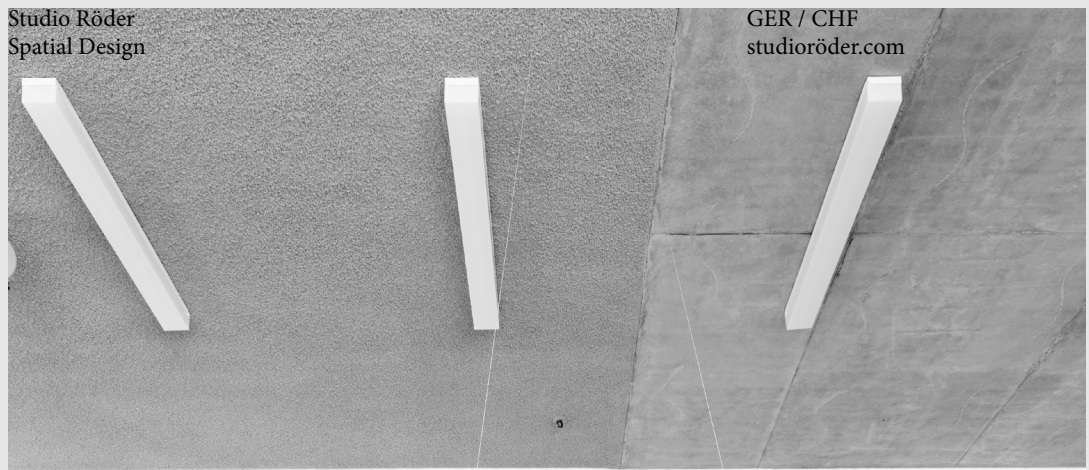



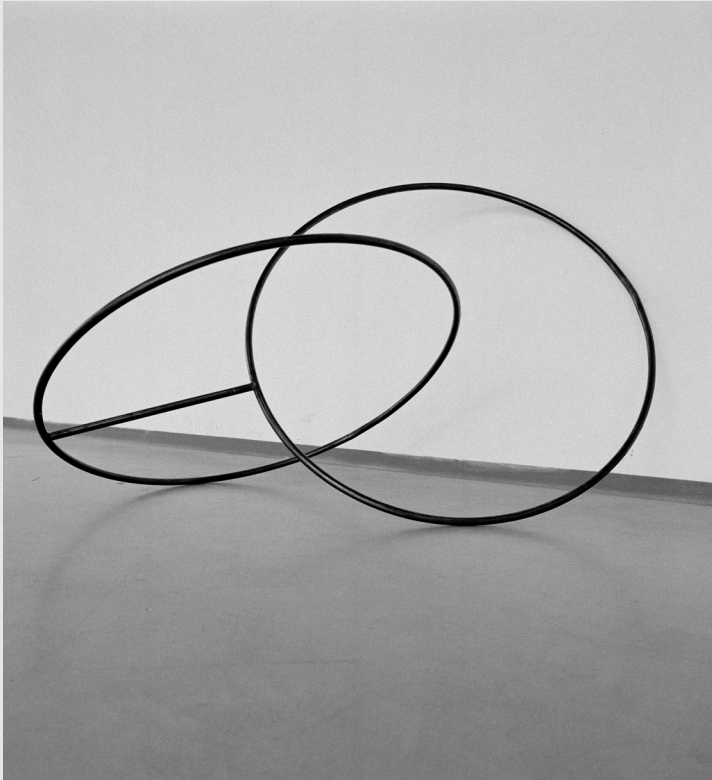

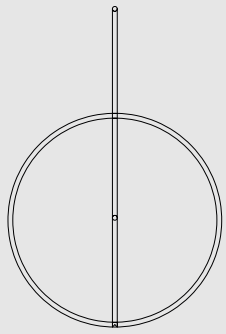
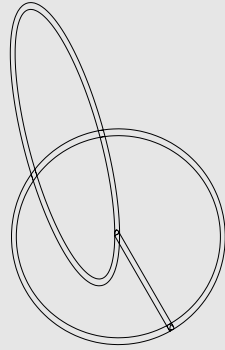
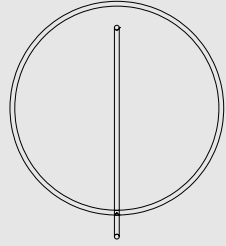
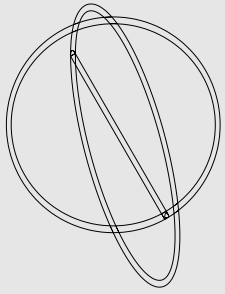
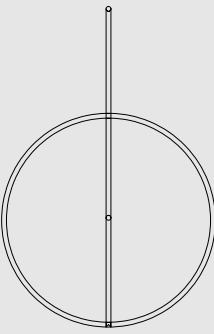
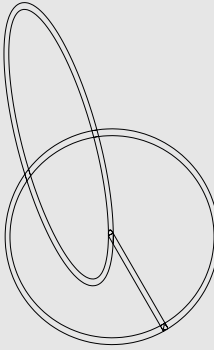
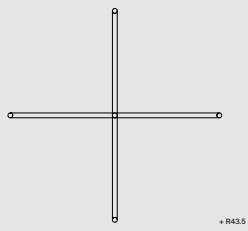
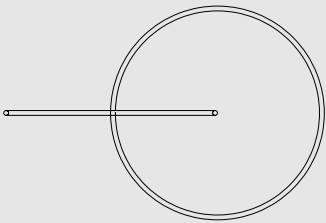
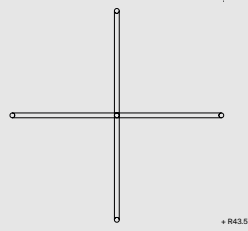
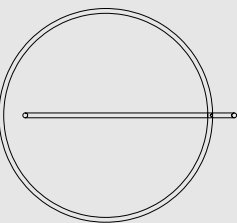
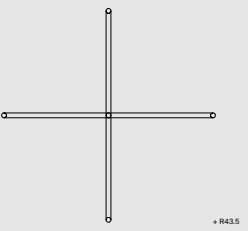
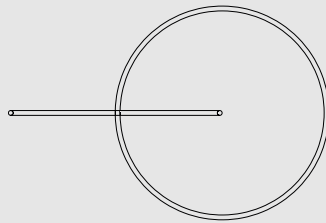

SR-S:03, 21

Spatial Basics  
Concrete, Stainless Steel, Wood, Silk

Scale: 1:25

A hybrid pavilion made of steel, concrete, and glass serves as both a studio and exhibition space. With a circular form in the centre and a skylight that opens to the sky, an open atmosphere is created for creative collaboration. The visible steel skeleton divides the space into four work areas through rotating metal doors, surrounded by continuous glass panels. Light can penetrate from all sides and allow the outside to play a strong role inside. A silk curtain also provides the option for privacy. At night, the circular form illuminates the dark room and connects with its surroundings. The four work areas can be transformed into a fluid exhibition space by opening the steel doors, where artists can come together, discuss, and present their works.

Note:

In this project, detail-scalings at a scale of 1:10 were created to study elements of architecture on a larger scale. Additionally, a model of a foldable bench was developed as part of the pavilion, which combines formal and material elements. The scalings refer both to the overall project as well as the formal aspects of the design of the Gerrit Rietveld Academie in Amsterdam.





SR-S:03, 21 (Model)

Spatial Basics



Space





SR-S:03, 21 (Bench study)



Spatial Basics



Space

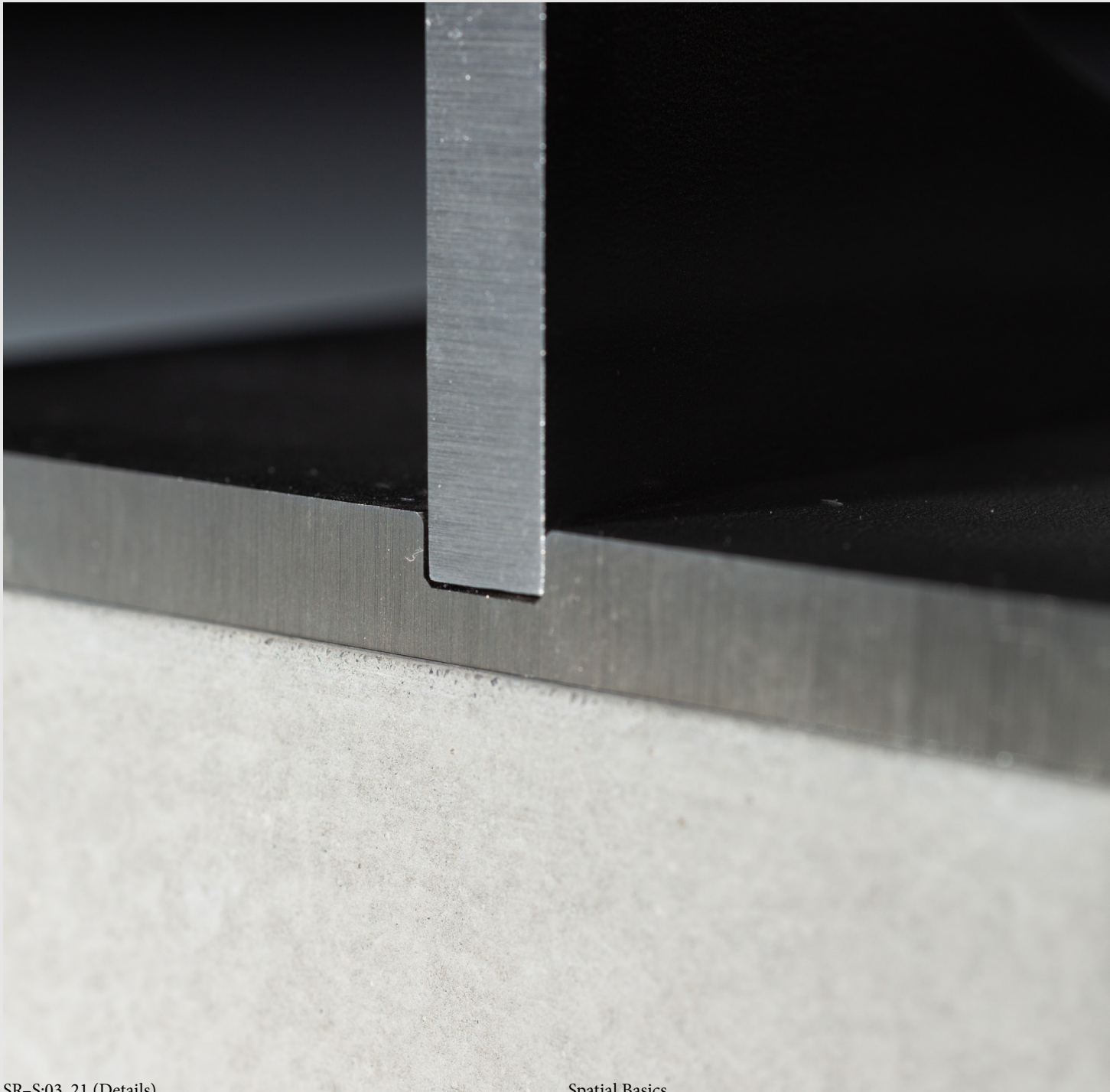

SR-S:03, 21 (Details)

Spatial Basics

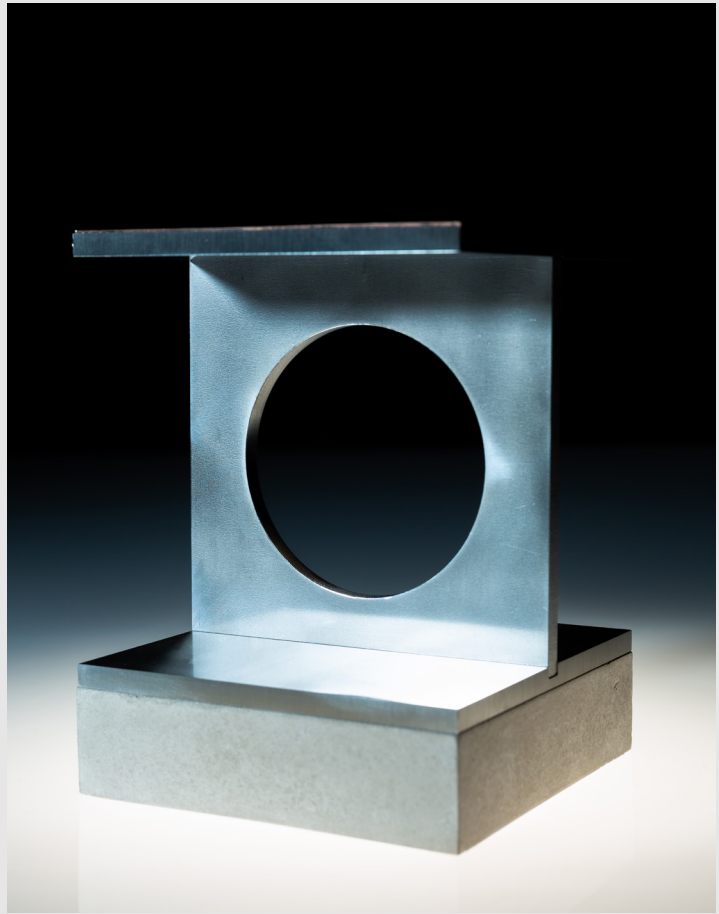

Space



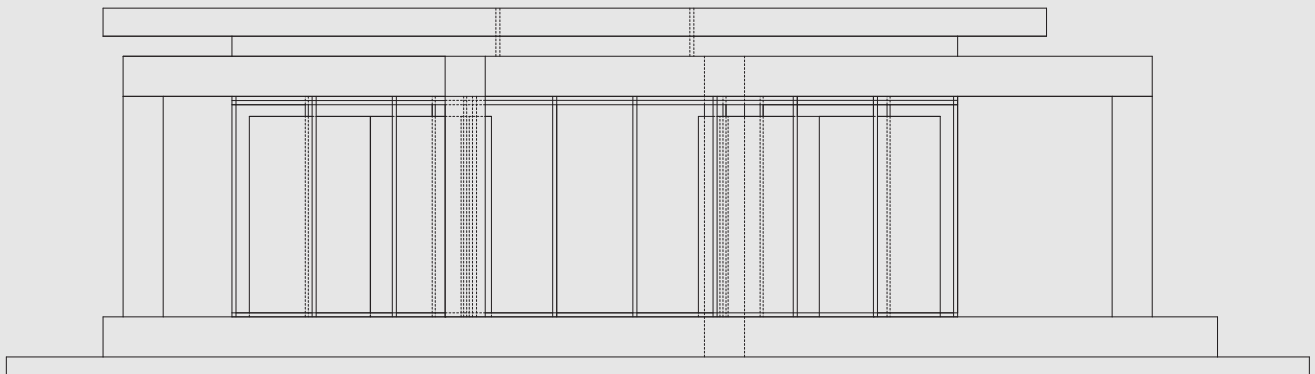
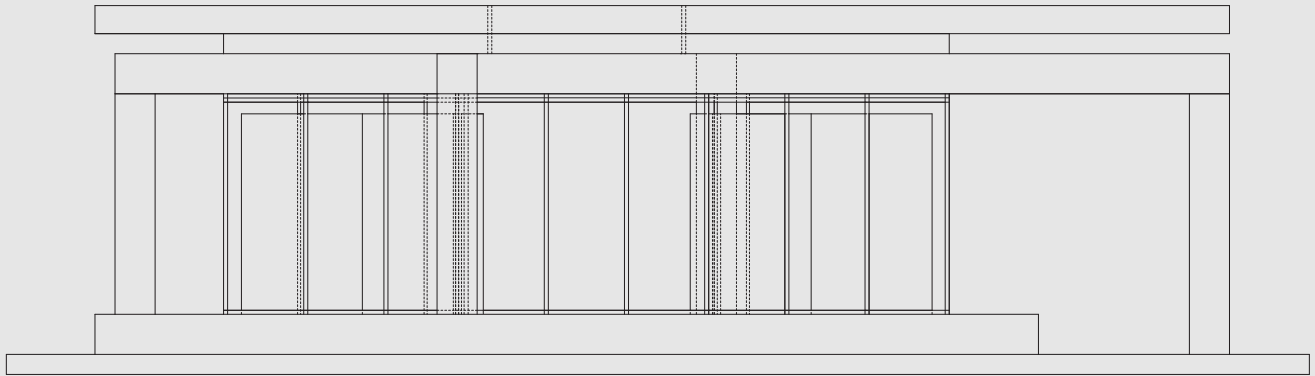

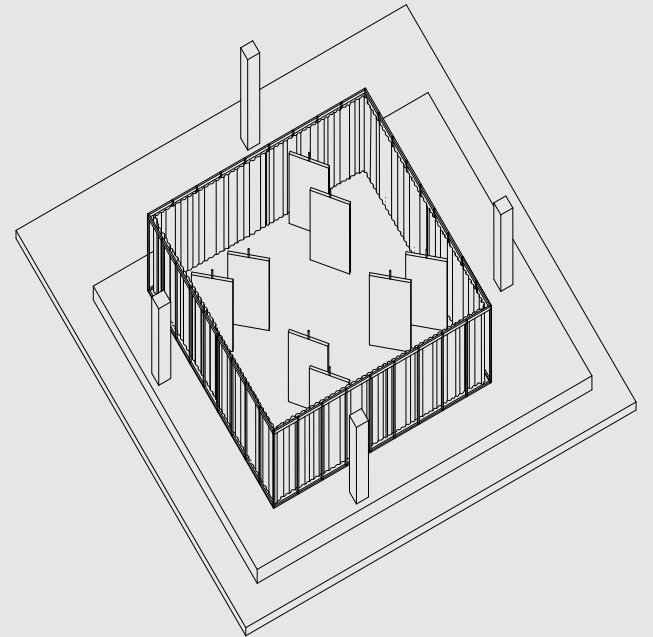
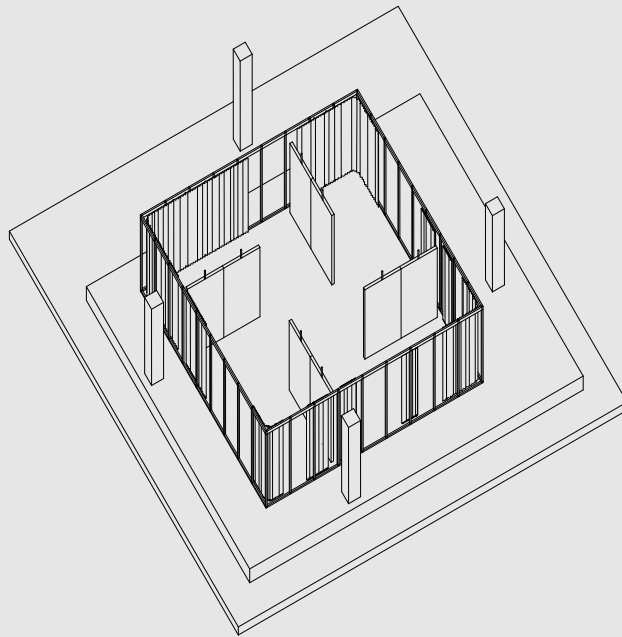
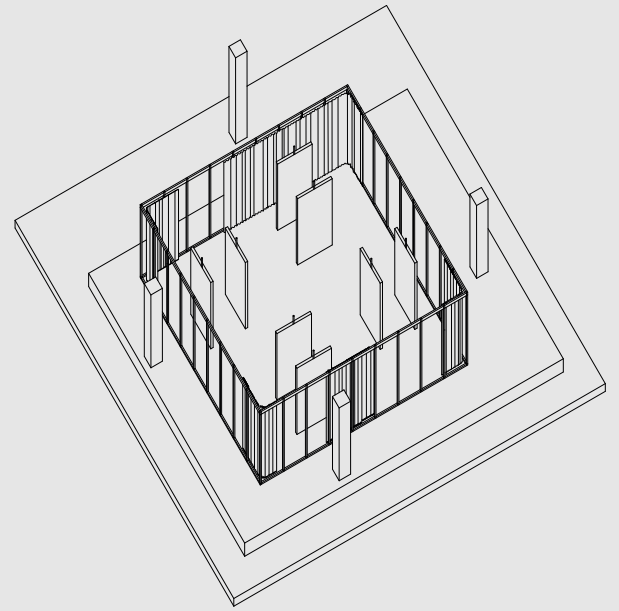
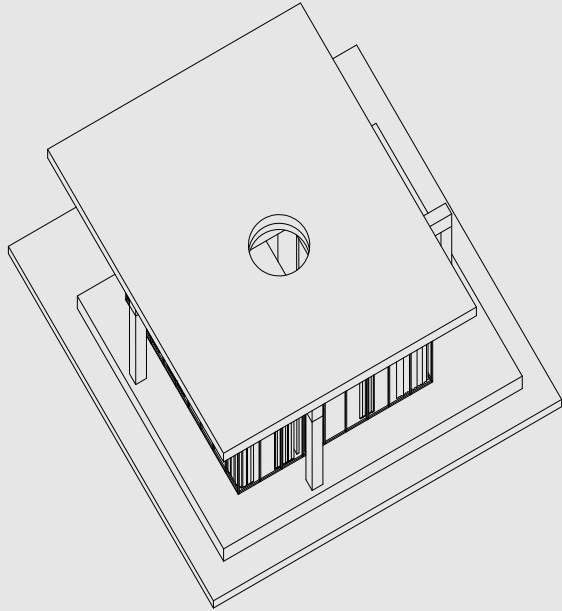

SR-S:04, 22

Route A/B  
Powder coated white aluminium, Stained birch wood,  
Translucent textile (EN 13773 Standard)

Various Scalings

Route A / Route B is a travelling exhibition with a total of 6 stations. It combines the spatial and material qualities of the exhibited places with those of the objects on display. Route A shows the diversity of handmade glass production. Route B exhibits drinking vessels that take up the theme of water and wine. Constructive-modular elements with supports that form height differences in the form of steps characterise the exhibition design. The colour withdrawal of all materials of the exhibition architecture allows an unadulterated view of the intrinsic colours of the exhibits. The existing is contrasted by a large-scale fabric hanging.





SR-S:04, 22

Route A/B

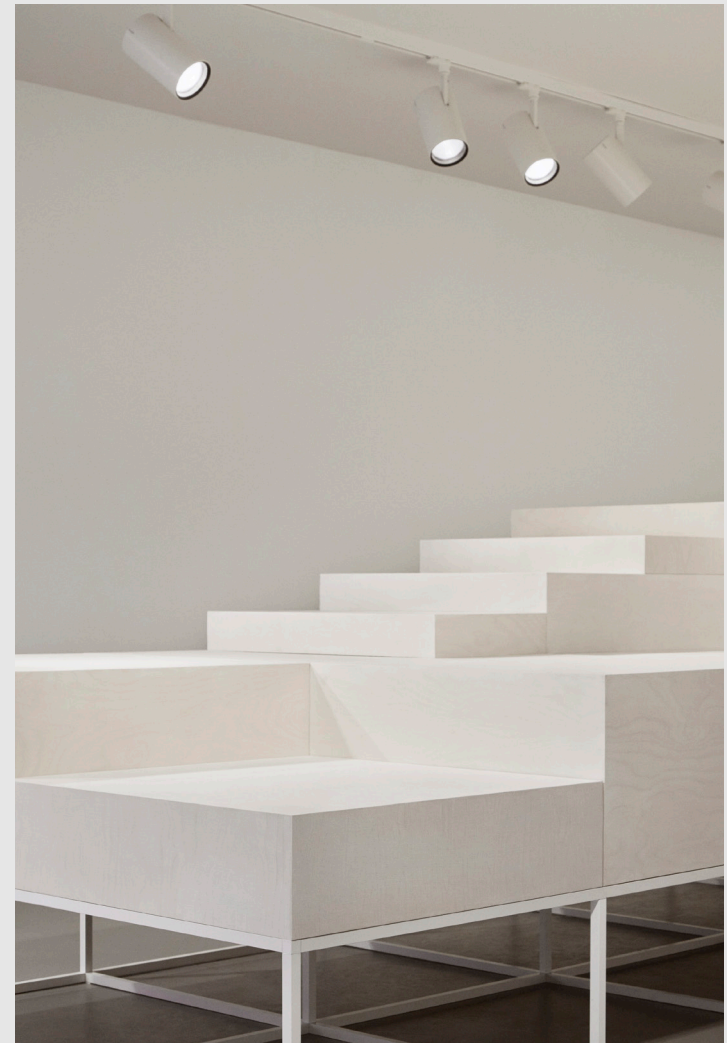

Space





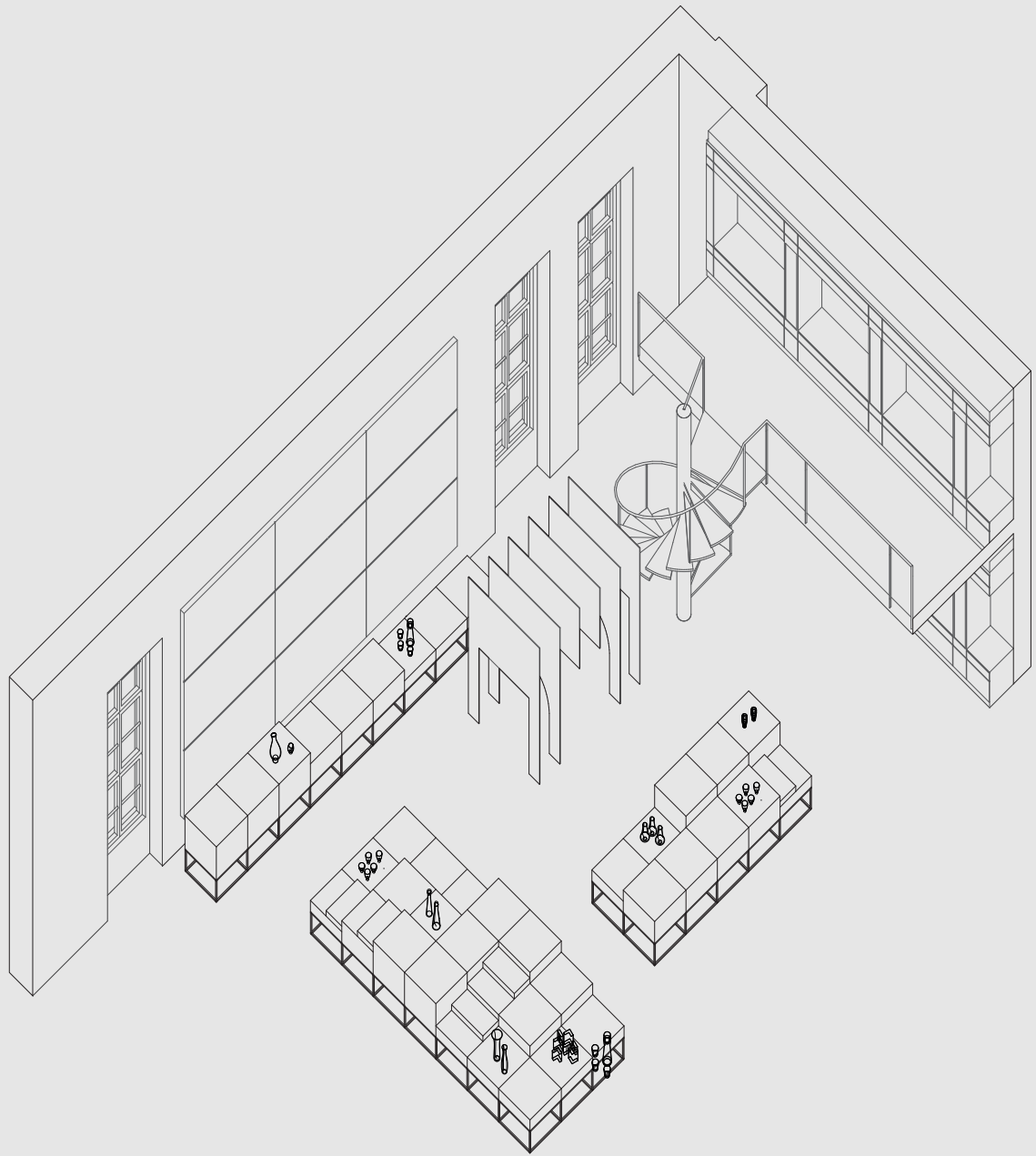

Selected Works

2018

2023